

#5275704 Pump

(12 Volt, 11 Amp, 3.8 G.P.M., 45 P.S.I.)

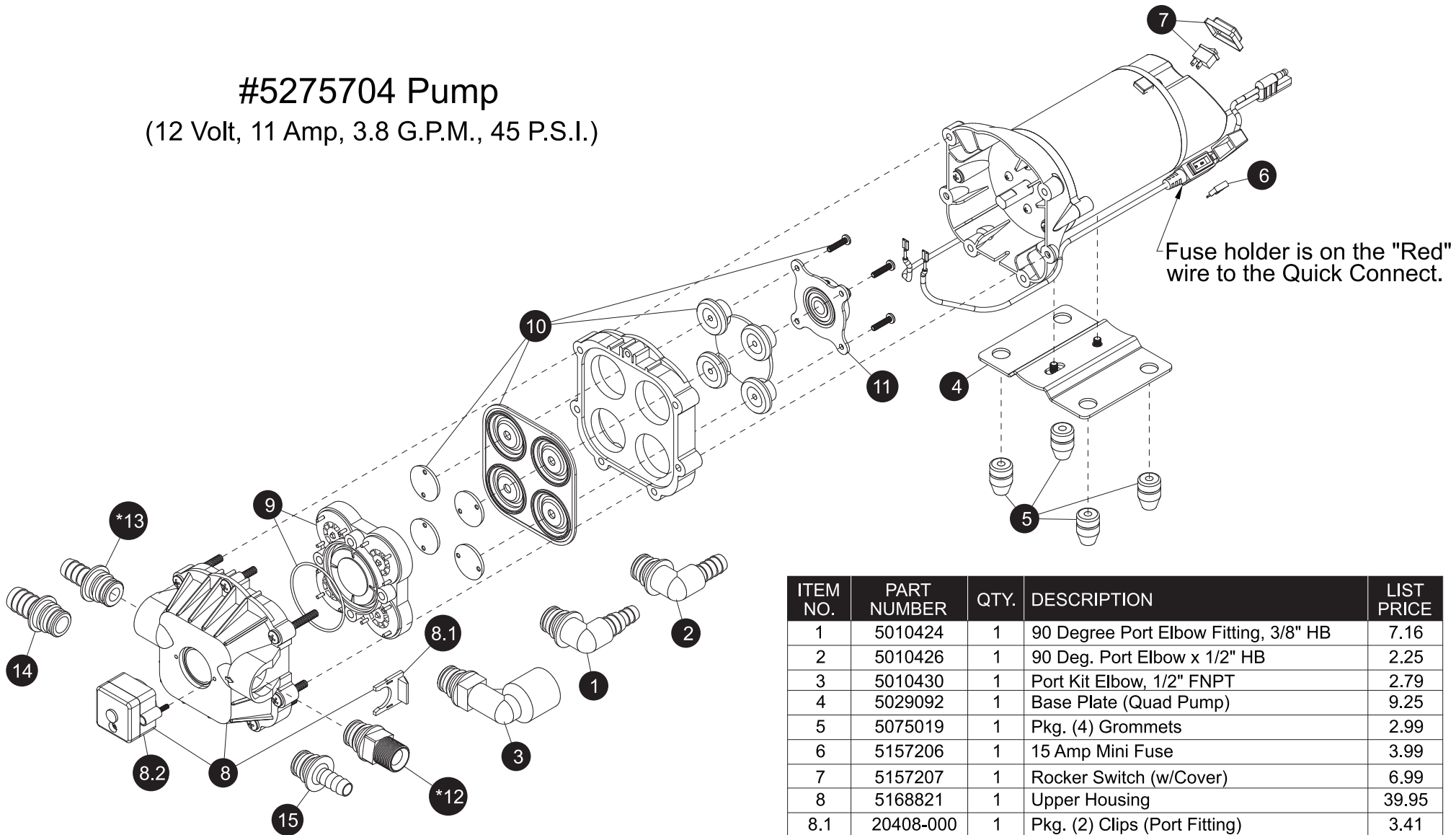

NOTE:
Fittings with an asterisk (*) by them are included with this pump. All others shown are optional fittings.

ITEM NO.	PART NUMBER	QTY.	DESCRIPTION	LIST PRICE
1	5010424	1	90 Degree Port Elbow Fitting, 3/8" HB	7.16
2	5010426	1	90 Deg. Port Elbow x 1/2" HB	2.25
3	5010430	1	Port Kit Elbow, 1/2" FNPT	2.79
4	5029092	1	Base Plate (Quad Pump)	9.25
5	5075019	1	Pkg. (4) Grommets	2.99
6	5157206	1	15 Amp Mini Fuse	3.99
7	5157207	1	Rocker Switch (w/Cover)	6.99
8	5168821	1	Upper Housing	39.95
8.1	20408-000	1	Pkg. (2) Clips (Port Fitting)	3.41
8.2	5157203	1	Pressure Switch Assembly	23.95
9	5168824	1	Check Valve Kit w/O-Ring & Ferrules	24.99
10	5168826	1	Diaphragm Kit w/Pistons & (4) Screws	19.96
11	5168828	1	Cam/Bearing Kit, w/Set Screw	12.95
*12	5168832	1	Port Kit Fitting, 1/2" MNPT	2.24
*13	5168833	1	Port Kit Fitting, 1/2" Hose Barb	2.24
14	5168835	1	Port Kit Fitting, 5/8" Hose Barb	2.24
15	5168836	1	Port Kit Fitting, 3/8" Hose Barb	2.24